

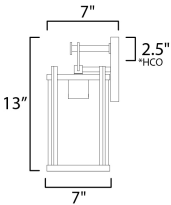

PRODUCT DESCRIPTION

Squared columns in Matte Black finish tower above the cylindrical glass shade rated for outdoor applications. Available in a more modern clear glass option or hammered glass. A rectangular hook detail carries the square form through to the backplate. A modern interpretation of a bell tower, these outdoor pendants and sconces are a cleaned up, transitional look for exteriors.



*height from center of outlet to the top of the fixture

MEASUREMENTS

DIMENSION : 7" W x 13" H x 7" Ext
BACK PLATE : 4.75" W x 6.25" H x 2.5" HCO
HANGING WEIGHT : 3.74 lb

LAMPING

INPUT VOLTAGE : 120V
BULB : 60W Incandescent E26 Medium , 60W Total
BULB INCLUDED : (Not Included)
LIGHTING_DIRECTION : Down

FINISHES OPTION

 Black (BK)

GLASS

Clear CL

MATERIAL

Aluminum, Glass

RATINGS

cETLus
Wet Location



ADDITIONAL

INSTALL UP/DOWN: Down
RATED LIFE 2500 Hours
OPERATING TEMPERATURE:
-20°C (-4°F), 40°C (104°F)

Always consult a qualified electrician before installing any lighting product.

STUDIO•M

Modifications or Customizations: Please email contract@studiomlighting.com
Sample Request: Please email order@studiomlighting.com with subject line
"Sample Order_ [Project Name] / [Specifier/Designer]"
All samples are subject to Studio M approval and must show proof of project and/or explanation.

Job Name:	Job Type:
Quantity:	Comments